

## PRODUCT SUBMITTAL - Termination Bar - Type L (Lip)

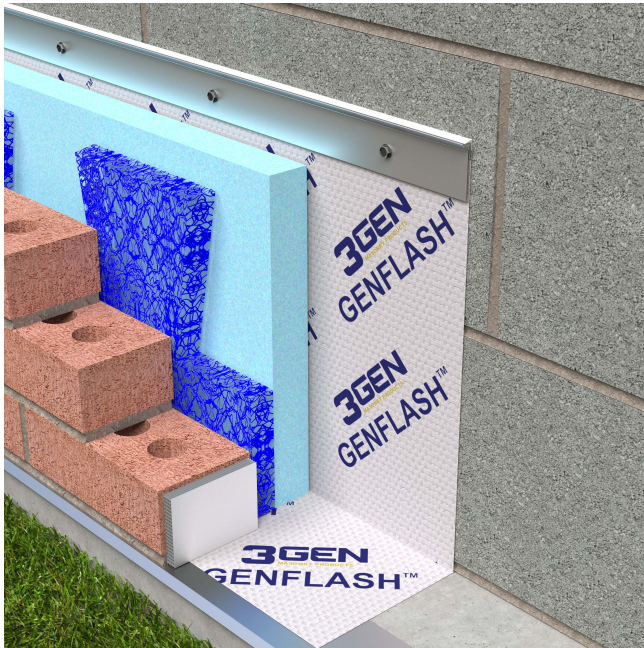

### Recycled Content:

Stainless Steel (Type 304)	Aluminum
68% Post-Consumer	60% Post-Consumer
18% Post-Industrial	20% Post-Industrial

### Material conformance:

Termination Bar (Lip) is used to mechanically secure the top of surface mounted flashing to the substrate and is compatible with all flashing products.

Termination Bar (LIP) is designed with a 45 Degree Lip to allow for proper placement of sealant.

Recommended fastening of Termination Bar (LIP) is 8" o.c.

Stainless Steel: Type 304 ASTM A240 / A240M,

ASTM A480 / A480M & ASTM A666.

Aluminum ASTM B221 / ASTM B221M

### Sizes/Finishes:

Aluminium (LIP) Size: 14 gauge x 1" x 8ft long.

Stainless Steel (LIP) Size: 26gauge x 1 1/2" x 8ft long.

Holes: 9/32" diameter holes spaced 8" o.c.

Termination Bar (LIP) Finish:

Aluminum	Stainless Steel (Type 304)
----------	----------------------------

In order to email your submittal sheet information, you must have Adobe Acrobat installed on your computer.

### NOTE

The information provided herein is for general informational purposes only and does not constitute a professional opinion or engineering judgment. It is not intended to replace the design, detailing, or project-specific determinations of the licensed architect or engineer of record.

Each project is unique. The selection, application, suitability, and proper installation of these products are the sole responsibility of the design professional and installer based on project-specific conditions, substrate, exposure, and applicable codes.

All products and information referenced herein are subject to 3GEN Masonry Products, Inc.'s Terms and Conditions of Sale, including all limitations of liability, disclaimers of warranties, and exclusive remedies, as published and in effect at the time of sale.

#### Mailing Address

8528 Davis Blvd., #134-246 North  
Richland Hills, TX 76182 Tel#:  
1-800-556-5785

[3genmp.com](http://3genmp.com)

#### Warehouse Address

8550 Parkway Drive Leeds,  
AL 35094 Tel#:  
1-800-556-5785