

PRODUCT SUBMITTAL - DOUBLE EYE

Double Eyes are used with Hook (Pintle)

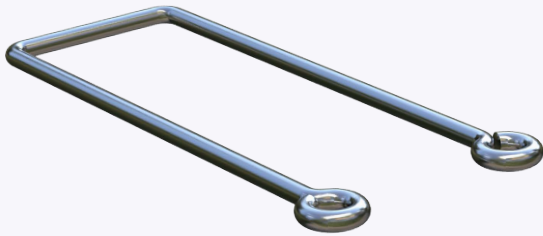

Recycled Content:

85% Post-Consumer 10% Post-Industrial

Material Conformance:

Double Eyes are used with Hook (Pintle) Recommended
Spacing is 16" O.C.

Meets TMS 402/602 & ACI / ASCE 530 Building Code
Requirements and Specification for Masonry Structures

Wire: (Carbon Steel) ASTM A1064 / A1064M

Tensile Strength: 80,000 psi. - Yield Point 70,000 psi.

Hot Dip Galvanized after fabrication.

ASTM A153 / ASTM A153-B2 (1.5 oz/ft)

Product Details:

Double Eye Diameter: 3/16"

Double Eye Finish: Hot Dip Galvanized

Double Eye Length:

4 3/4" 5 3/4"

NOTE

The information contained on this submittal sheet does not constitute any professional opinion or judgement and should not be used as a substitute for any architect or engineer professional determinations. Each construction project is unique and the use of these products is the responsibility of the architects, engineers and other professionals who are familiar with the specific design of the project.

Mailing Address

8528 Davis Blvd., #134-246 North
Richland Hills, TX 76182 Tel#:
1-800-556-5785

3genmp.com

Warehouse Address

8550 Parkway Drive Leeds,
AL 35094 Tel#:
1-800-556-5785