

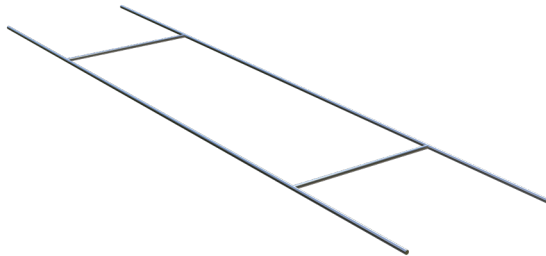

# PRODUCT SUBMITTAL - LADDER REINFORCING

Ladder Joint reinforcing is designed for embedment in the horizontal mortar joints of concrete masonry units.



## Recycled Content:

85% Post-Consumer 10% Post-Industrial

## Material Conformance

Ladder Joint reinforcing is designed for embedment in the horizontal mortar joints of concrete masonry units.

ASTM A951/A951M (Standard Specification for Steel Wire for Masonry Joint Reinforcing.)

Meets TMS 402/602 & ACI / ASCE 530 Building Code Requirements and Specification for Masonry Structures

Wire: (Carbon Steel) ASTM A1064 / A1064M

Tensile Strength: 80,000 psi. - Yield Point 70,000 psi.

Mill Galvanized ASTM A641 / ASTM A641M (0.1 oz/ft)

Hot Dip Galvanized after fabrication.

ASTM A153 / ASTM A153-B2 (1.5 oz/ft)

## Product Details

Ladder is manufactured in 10-foot-long pieces with cross rods welded at 16 inches on center, starting 12 inches from the end to ensure proper overlap, as required by TMS 602 Specification 3.4 B.11(b), which requires a minimum 8-inch lap splice for joint reinforcement.

Wire deformations meet ASTM A951

## Finishes

☐ Mill Galvanized

☐ Hot Dip Galvanized

## Wire Diameter:

☐ Standard

☐ Heavy Duty

☐ Extra Heavy Duty

## Side Rods

9 Gauge (.148")

3/16" (.187")

3/16" (.187")

## Cross Rods

9 Gauge (.148")

9 Gauge (.148")

3/16" (.187")

## CMU / Block Size

3" ☐ 4" ☐ 5" ☐ 6" ☐ 8" ☐ 10" ☐ 12" ☐

**RESET EMAIL PRINT**

## NOTE

The information contained on this submittal sheet does not constitute any professional opinion or judgement and should not be used as a substitute for any architect or engineer professional determinations. Each construction project is unique and the use of these products is the responsibility of the architects, engineers and other professionals who are familiar with the specific design of the project.

## Mailing Address

8528 Davis Blvd., #134-246  
North Richland Hills, TX 76182  
Tel#: 1-800-556-5785

**3genmp.com**

## Warehouse Address

8550 Parkway Drive  
Leeds, AL 35094  
Tel#: 1-800-556-5785