

# PRODUCT SUBMITTAL - NEOPRENE EXPANSION JOINT

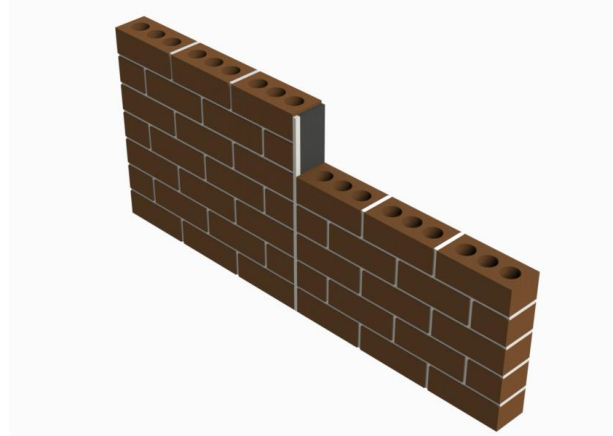

### Material Conformance

Closed-cell Neoprene is durable and water-resistant. It can handle up to 50% compression, and is manufactured to meet ASTM D 1056, RE41 Grade 2A1.

### Neoprene Expansion Joint

□ 3/8" X 3" X 50 FT Long

Physical Properties	Typical Value
Density	3 to 10 pounds per cubic foot (PCF)
Compression Set	Up to 50% compression recovery
Tensile Strength	Greater than 150 psi
Elongation at Break	100% to 400%
Temperature Range	-40°F to 200°F (-40°C to 93°C)
Water Absorption	Less than 5% by weight
Shore Hardness	20-30 Shore A
Thermal Conductivity	Low (Good insulation properties)
Chemical Resistance	Resistant to oils, chemicals, and ozone

**RESET    EMAIL    PRINT**

**NOTE**

The information contained on this submittal sheet does not constitute any professional opinion or judgement and should not be used as a substitute for any architect or engineer professional determinations. Each construction project is unique and the use of these products is the responsibility of the architects, engineers and other professionals who are familiar with the specific design of the project.

**Mailing Address**  
 8528 Davis Blvd., #134-246  
 North Richland Hills, TX 76182  
 Tel#: 1-800-556-5785

**3genmp.com**

**Warehouse Address**  
 8550 Parkway Drive  
 Leeds, AL 35094  
 Tel#: 1-800-556-5785